



NMRV蜗杆减速机 NMRV WORM REDUCER

杭州安久传动有限公司
Hangzhou Ang Drive Co., Ltd.



杭州安久传动有限公司
Hangzhou Ang Drive Co., Ltd.
Tel : 0086 571 82101305
Email : info@angdrive.com
Website : www.angdrive.com

我们立足于长期的精心科研和先进的管理理念，利用精良的生产和检测设备，以高品质的产品和完善周到的服务争取市场，帮助客户在全球范围内取得成功。

Based on constant research, advanced management, sophisticated production and testing equipment, we develop market with high-quality products and thoughtful service, so as to help customers achieve success all over the world.



企业简介

杭州安久传动有限公司主要经营蜗杆减速机、齿轮减速机、交流与直流电机以及相关传动产品。

公司严格执行质量管理体系，从开发设计，原料采购，进料检验、一贯化制程到成品包装出货，皆层层严格把关，期望为广大客户提供高性能、低成本、更适合的专业传动方案。

我们坚持优质产品、优质服务，为客户创造价值，让客户满意。

ANG Drive is specialized in worm gearbox, helical gearbox, AC & DC motor, and related transmission products.

The company strictly implements the quality management system, from design & development, raw material procurement, incoming inspection, consistent process to the finished product packaging & delivery, and expects to provide our customers with high performance, competitive price and more suitable transmission solutions.

We insist on high-quality products and services to create value for customers and satisfy customers.

蜗轮减速机概述 Product summary

NMRV系列蜗轮减速机是在原有WP系列产品基础上，融合国际先进的技术，研制开发的新一代产品，采用先进的方箱结构，优质的铝合金高压压铸成形，具有体积小、重量轻、高强度、散热快、美观耐用。

减速器输出扭矩大、传动平稳噪音小，采用全封闭结构、密封性好、免维护、可适应全方位安装。

NMRV series worm gear reducer is in original reference series product basis, combining the international advanced technology, research and development of a new generation of products, adopts advanced square box structure, high quality aluminum alloy with high-pressure whole-coasting, small volume, light weight, high strength, heat faster, attractive and durable.

Reducer output torque, smooth transmission noise is small, adopt totally closed structure, good sealing, free of maintenance, can adapt to comprehensive installation.

使用与安全保障 Use and safety guarantee

1. 使用前请确定蜗轮减速机与机械安全配套强度，在蜗轮减速机性能参数安全范围内。
2. 蜗轮减速机出厂时已加注WA460润滑油，在开始运行400小时，应更换润滑油，以后换油周期约为4000小时。
3. 蜗轮减速机箱体内存留足够的润滑油，并定时检查油量。
4. 安装时避免锋利器具碰伤输出轴油封造成减速箱漏油。
5. 与机械连接前请确认旋转方向，若旋转方向不正常有可能受伤或破坏装置。
6. 在旋转部位请设置安全罩等，防止受伤。
7. 搬动时若发生脱落或倾倒，很危险，请充分注意。

1. Before use, please determine worm gear reducer and mechanical safety supporting intensity, the worm gear reducer performance parameters safety range.
2. Worm gear reducer factory has WA460 lubricating oil, filling in starting operation 400 hours, should be replaced, lubricating oil cycle after about 40 hours.
3. Worm gear deceleration cabinet body should retain enough oil, and regularly check the amount of oil.
4. when installation, avoid sharp instruments bruising output shaft seal cause reducer leakage.
5. And mechanical connection rotation direction, before please confirm if the rotation direction is not normal possible injury or damage device.
6. In rotating parts please set safety is overspread etc, to prevent injury.
7. Move when if produce deciduous or dump, dangerous, please full attention.



蜗轮减速机的特点 Characteristics

- 1、不占空间
蜗轮减速机与马达组装时、出力轴方向安装空间大，中空型减速机轴心与马达可成直角状态，占用空间小有利于机器小型化。
Occupied no space
The space requirement for the installation of output shaft is considerably large while assembling motor or reduce. The installation of hollow type reducer may form right Angle with motor, thus facilitate miniaturize of the machine.
- 2、具有自锁功能
应用场合需微保持力，可直接使用，省却安装制动装置。
Self locking
For the place require for minor holding force, save the cost of baking device, such as in slope conveyor.
- 3、快速停止
一般齿轮减速机，停止时间约需要5-10秒，但使用NRV系列产品只需要2-5秒就可达到静止状态。
Fast stop
The ordinary gear reducer available in market requires 5-10seconds stop time. but NRV series product need only 2-5 seconds to reach state of still.
- 4、搭配性高
中空轴选装方便，单方向出力型或双出力轴型，轴心换装方便。
High accommodation
You may select from hollow shaft. uni-direction output shaft or dal output shaft, easy to modify, only one minute to complete the dissemble and assemble of shaft.
- 5、安全性高
使用不同于传统的传动方式，免链轮、皮带轮，传动结构密封不外露，可直接驱动。减少对作业人员的伤害。
High safety
Use transmission different from conventional method, no sprocket pulley is needed, no exposed transmission structure, reduce the possibility of operator.
- 6、防护性佳
防水、防尘，减速机防护等级IP55构造，对于粉尘及水气有良好的隔离功能。
Good protection
Water, dust proof, the protection class Ip55 possesses, good isolation to dust and moisture.
- 7、可多面安装，无角度限制
全系列产品，每个平面，都有固定孔，你可以选择安装时所需的方向、角度安装。
Allow multiple sides installation, no restriction in angle
There are holes for mounting on all plains of the series of product for your selection of direction and angle required.
- 8、散热佳
机壳采用铝合金重力压铸一体成型，散热快，蜗杆、蜗轮寿命延长，而使用性能佳。（使用中外壳发热属正常状况）。
Good cooling effect
One formation aluminum alloy for casing, quigley heat dissipation extended life for worm lever, worn gear, good durability(wormca-sing during running is normal)
- 9、维修方便
因为不同于传统的装置方式，你勿需再拆装、链轮、链条，只需拆装减速机的固定座既可轻松完成换装。
Easy maintenance
Different from conventional mounting method, you den't need the dissemble the sprocket, pulley but only dissemble and assemble the mounting base of the reducer to compete the modification easily.
- 10、无厂牌限制
可配套的普通马达系列、或I (RK) 15W-200W马达，可轻易装配无需另外加工。
No restriction on brand
Match with 15W-200W paese or domestic product available in market without further processing.
- 11、宽广的减速比
由于采用分离型装配，可轻易的变换减速比，从30-20000。
Wide reduction ratio
Easily change the reduction ration from 30-20000 due to detached assemble.
- 12、相配马达可以附刹车器，与蜗轮减速机一体成形美观实用。
May complete with brake, clutch in one formation aesthetic and practice.

蜗轮减速机型号 Versions

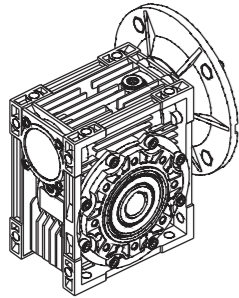
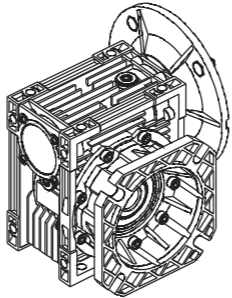
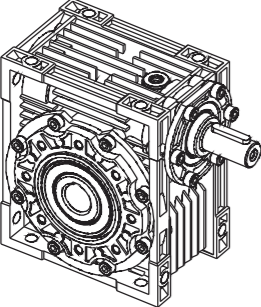
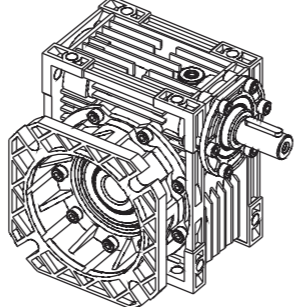
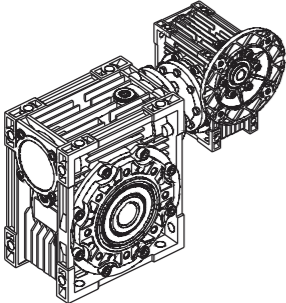
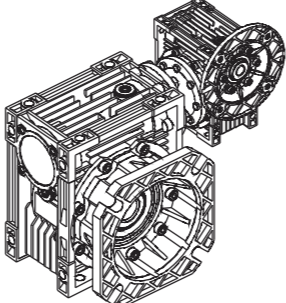
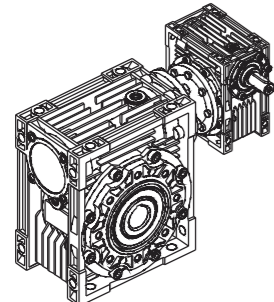
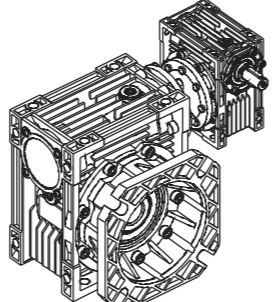
	NMRV 025-130	NMRV 025-130 F	
	NRV 025-130	NRV 025-130 F	
	NMRV-NMRV 025-130	NMRV-NMRV 025-130 F	
	NRV-NMRV 025-130	NRV-NMRV 025-130 F	

NMRV/NRV

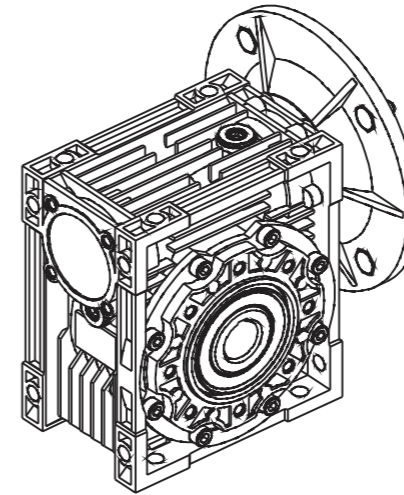

NMRV

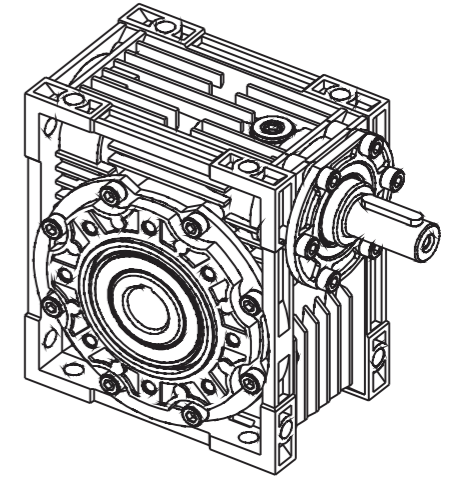

NRV

NMRV型号标记 NMRV Model & marker

NMRV-063-30-VS-F1(FA)-AS-80B5-0.75kW-B3	
NMRV	蜗轮减速机 Worm geared motor
NRV	蜗轮减速机 (配接输入轴) Worm reduction unit
063	蜗轮减速机中心距 Center distance
30	减速比 Reduction ratio
VS	双向输入轴 Double input shaft
AS	单向输出轴 Single output shaft
PAM	电机联接 Fitted for motor coupling
0.75kW	电机功率 Electric motor power
F1(FA)	输出法兰位置及型号 Output flange
AB	双向输出轴 Double output shaft
80B5	电机机座号和安装结构形式 Motor mounting facility
B3	安装方位 Mounting position

马达直联尺寸 Predisposition

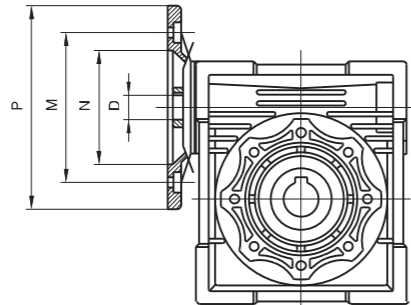

NMRV	PAM IEC	N	M	P	D															
					5	7.5	10	15	20	25	30	40	50	60	80	100				
025	56B14	50	65	80	9	9	9	9	9	-	9	9	9	9	-	-				
	63B5	95	115	140	11	11	11	11	11	11	11	11	11	-	-	-				
030	63B14	60	75	90	9	9	9	9	9	9	9	9	9	9	9	-				
	56B5	80	100	120	14	14	14	14	14	14	14	14	-	-	-	-				
040	71B5	110	130	160	11	11	11	11	11	11	11	11	11	11	11	11				
	71B14	70	85	105	-	-	-	-	-	-	-	-	9	9	9	9				
	63B5	95	115	140	19	19	19	19	19	19	19	-	-	-	-	-				
	63B14	60	75	90	14	14	14	14	14	14	14	14	14	14	14	-				
050	80B5	130	165	200	-	-	-	-	-	-	-	-	11	11	11	11				
	80B14	80	100	120	24	24	24	24	24	24	24	-	-	-	-	-				
	71B5	110	130	160	-	-	-	-	-	-	-	14	14	14	14	14				
	71B14	70	85	105	-	-	-	-	-	-	-	14	14	14	14	14				
063	90B5	130	165	200	28	28	28	-	-	-	-	-	-	-	-	-				
	90B14	95	115	140	24	24	24	24	24	24	24	24	-	-	-	-				
	80B5	130	165	200	-	-	-	-	19	19	19	19	19	19	19	19				
	80B14	80	100	120	-	-	-	-	-	-	-	-	14	14	14	14				
	71B5	110	130	160	-	-	-	-	-	-	-	-	14	14	14	14				
075	100/112B5	180	215	250	38	38	38	38	38	-	-	-	-	-	-	-				
	100/112B14	110	130	160	28	28	28	28	28	28	28	28	28	28	-	-				
	90B5	130	165	200	-	-	-	-	-	-	-	-	-	-	-	-				
	90B14	95	115	140	24	24	24	24	24	24	24	24	24	24	-	-				
	80B5	130	165	200	-	-	-	-	-	-	-	19	19	19	19	19				
090	80B14	80	100	120	-	-	-	-	-	-	-	-	-	-	19	19				
	132B5	230	265	300	-	38	38	38	38	-	-	-	-	-	-	-				
	100/112B5	180	215	250	-	28	28	28	28	28	28	28	28	28	-	-				
	90B5	130	165	200	-	-	-	-	-	24	24	24	24	24	24	24				
110	80B5	130	165	200	-	-	-	-	-	-	-	-	-	-	19	19				
	132B5	230	265	300	-	38	38	38	38	38	38	38	-	-	-	-				
	100/112B5	180	215	250	-	-	-	-	-	28	28	28	28	28	28	28				
130	90B5	130	165	200	-	-	-	-	-	-	-	-	-	-	24	24				

安装方位 Mounting Positions

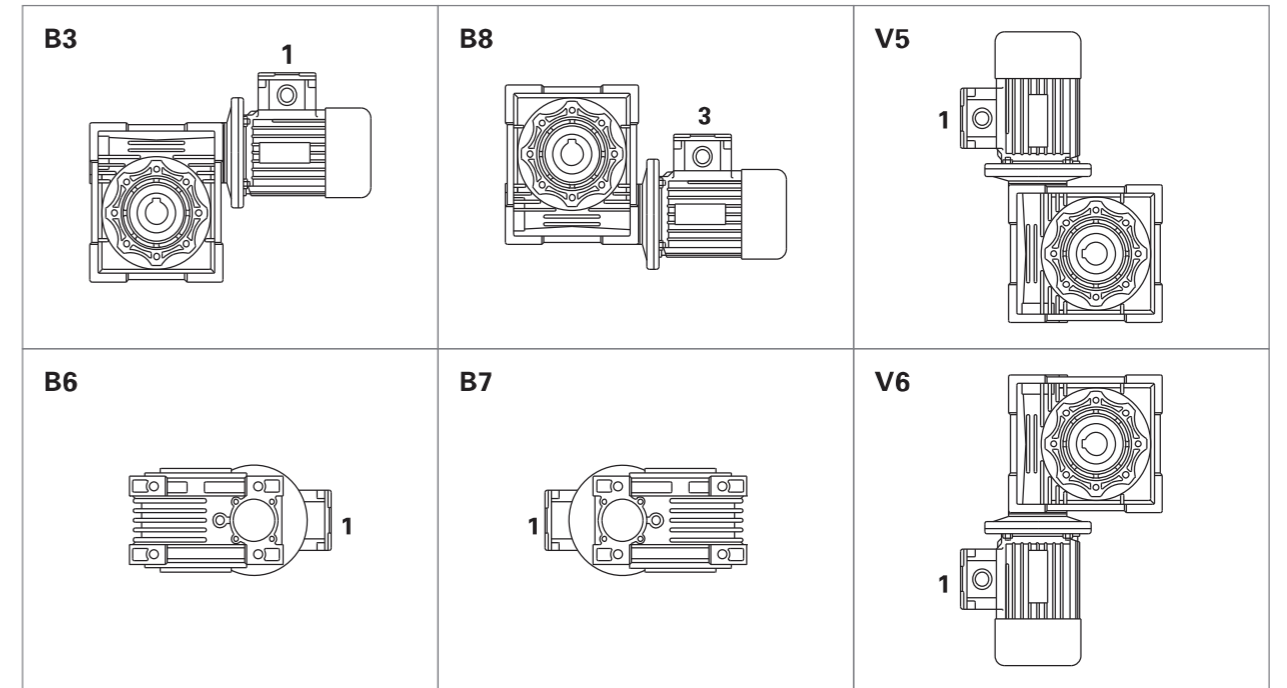

法兰位置 Flange F-FL

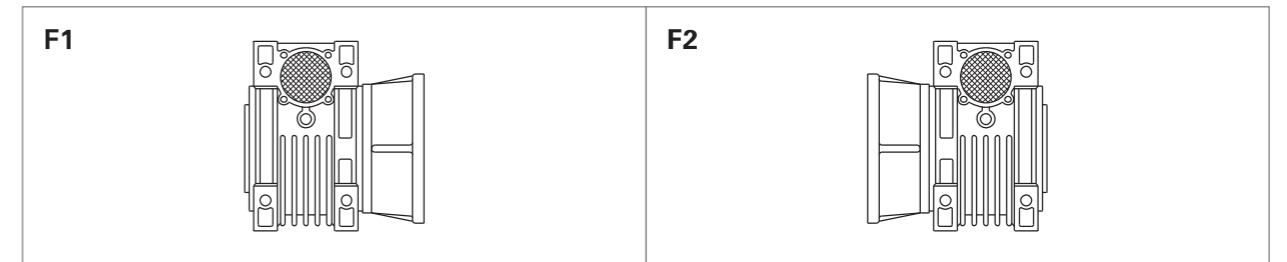

接线盒安装方式 Position of terminal box

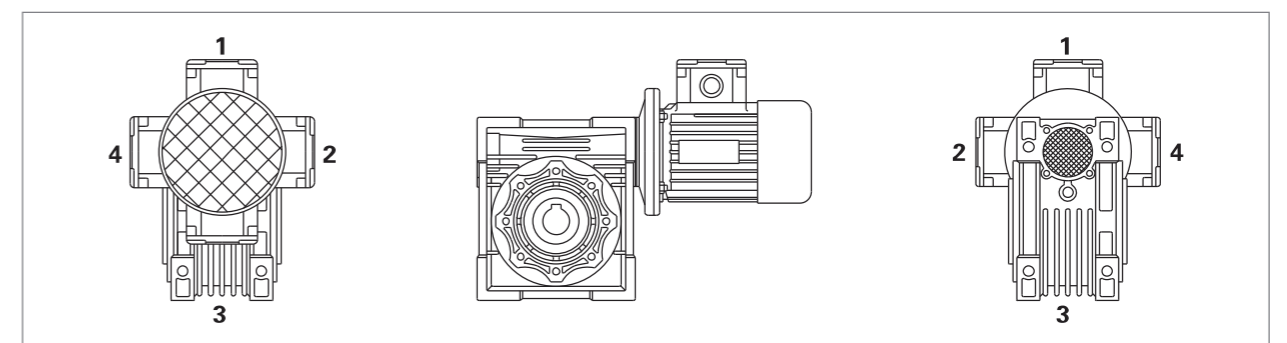

输出轴配置 Position of output shaft

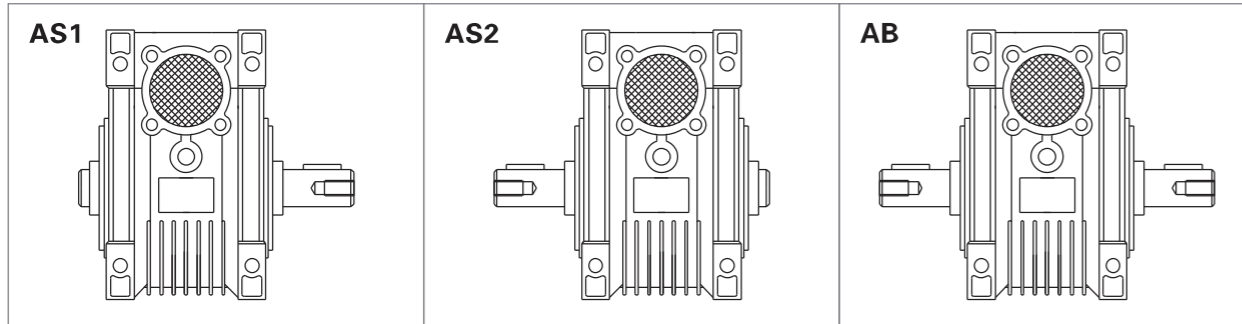

双向输入轴 Double extension worm shaft 扭力臂配置 Position of torque arm

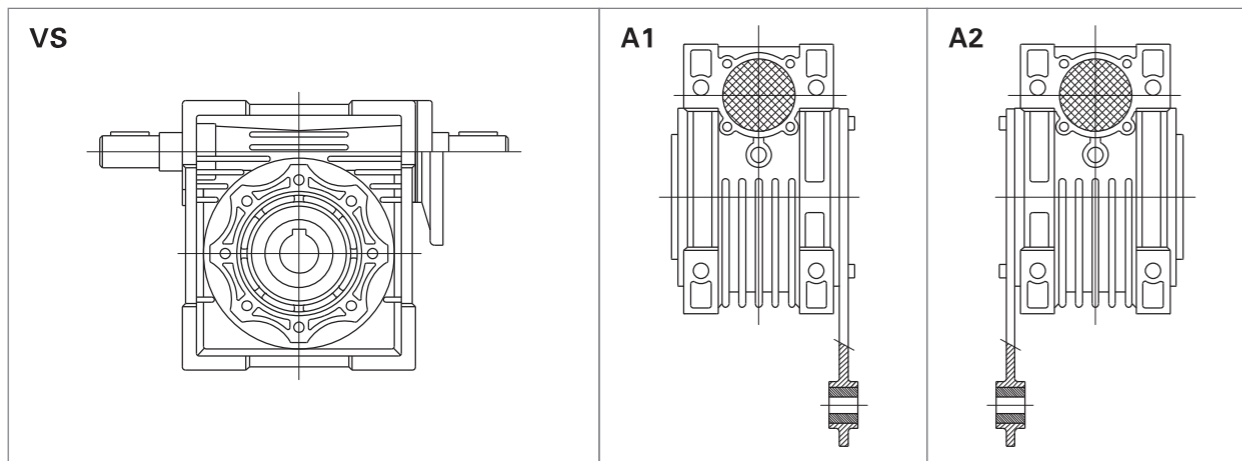

润滑油的选用 Choice of lubeicant

油量公升数 Q.ty of oil in litres									
NMRV	025	030	040	050	063	075	090	110	130
B3								3	4.5
B8								2.2	3.3
B6-B7	0.02	0.04	0.08	0.15	0.3	0.55	1	2.5	3.5
V5								3	4.5

	ISO	合成油 Synthetic	矿物油 Mineral
国内使用 Used in interior	VG32	VG320	VG320
	广研润滑	WA460	
国外使用 Used in foreign Countries	IP	TELIUM VSF	MELLANA OIL 220
	SHELL	TIVELA OIL SC320	OMALA OIL 220
	AGIP	BLASIA S320	BLASIA 220
	MOBIL	GLYGOYLE 30	MOBILGEAR 220
	CASTROL	ALPHASYN PG 320	ALPHA MAX 220

参数符号对应表 Parameter & symbol contrast table

P = 功率 Power (Kw)	η = 效率 Efficiency	a = 轴向 Axial
M = 扭力 Torque (Nm)	γ = 前置角 Helix angle	s = 静态 Statical
n = 速度 Speed (rpm)	f.s. = 工作系数 Service factor	d = 动态 Dynamic
i = 减速比 Ratio	1 = 输入轴 Input shaft	max = 最大值
F = 负荷 Load (N)	2 = 输出轴 Output shaft	min = 最小值
m = 重量 Weight (kg)	r = 径向 Radial	

输入轴许用径向载荷 Applied mid-way along the input shaft

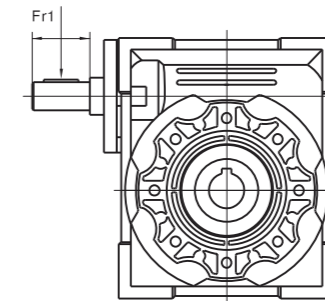

(N)

n1	NRV030	NRV040	NRV050	NRV063	NRV075	NRV090	NRV110	NRV130
1400	150	250	350	500	700	900	1200	1500
900	175	290	400	580	810	1040	1390	1740
500	210	350	490	700	980	1270	1700	2100

输出轴许用径向载荷 Applied mid-way along the output shaft

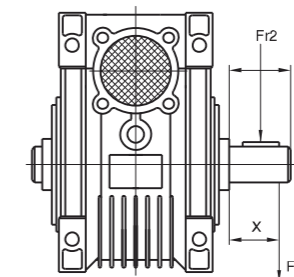

$$Fr_x = Fr \frac{a}{b+x}$$

(N)

n2	NRV025	NRV030	NRV040	NRV050	NRV063	NRV075	NRV090	NRV110	NRV130
400	390	530	1020	1400	1830	2160	2390	3020	3950
250	460	620	1200	1650	2150	2520	2800	3530	4610
150	550	740	1420	1960	2540	2990	3310	4180	5470
100	630	850	1620	2250	2910	3430	3800	4790	6260
60	740	1000	1920	2660	3450	4060	4500	5680	7420
40	850	1150	2200	3050	3950	4650	5150	6500	8500
25	990	1350	2570	3570	4620	5440	6020	7600	9940
10	1350	1830	3490	4840	6270	7380	8180	10320	13500

a	50	65	84	101	120	131	162	191	203
b	38	50	64	76	95	101	122	151	163

--表中的数值为作用于出力轴中点的许可加载力。
 --当减速机为双出轴时，折算到轴端的径向合力不能超过表中规定的数值。
 --当径向力和轴向力同时施加时，最大许可的轴向推力为径向力的1/5。
 --Above table is the allowed loading force on the midpoint of output shaft.
 --When the reducer is with double output shafts, the resultant radial power at the edge of shaft should not exceed the values specified as in above table.
 --The max allowed axial thrust is 1/5 of radial force while the radial force and axial force effected together.

性能参数表 Performance

P1(Kw)	n2(1/min)	M2(Nm)	F.S.	i	减速机型号Type	Fr2(N)	
0.06	280	1.8	6.2	5	NMRV025	439	
	186.7	2.6	4.2	7.5		503	
	140	3.4	3.5	10		553	
	93.3	4.9	2.5	15		633	
	70	6.1	2.0	20		697	
	46.7	8.2	1.6	30		798	
	35	10	1.3	40		878	
	28	12	0.9	50		946	
	23.3	14	0.7	60		1006	
	280	1.8	10.1	5		NMRV030	597
	186.7	2.6	6.9	7.5			683
	140	3.4	5.4	10			752
	93.3	4.7	3.8	15			861
	70	6	3.0	20			948
56	7	3.0	25	1021			
46.7	8	2.5	30	1085			
35	9.7	1.9	40	1194			
28	11	1.5	50	1286			
23.3	13	1.3	60	1367			
17.5	14	0.9	80	1504			
0.09	280	2.7	4.1	5	NMRV025		439
	186.7	3.9	2.8	7.5			503
	140	5.1	2.4	10			533
	93.3	7.3	1.6	15		633	
	70	9.2	1.3	20		697	
	46.7	12	1.1	30		798	
	35	15	0.9	40		878	
	280	2.7	6.7	5		NMRV030	597
	186.7	3.9	4.6	7.5			683
	140	5	3.6	10			752
	93.3	7.1	2.5	15			861
	70	9	2.0	20			948
	56	10	2.0	25			1021
	46.7	12	1.7	30			1085
35	14	1.2	40	1194			
28	17	1.0	50	1286			
23.3	19	0.9	60	1367			
28	19	2.0	50	2475			
23.3	21	1.7	60	2630			
17.5	26	1.3	80	2895			
14	29	1.0	100	3118			
0.12	280	3.6	5.1	5	NMRV030	597	
	186.7	5.2	3.4	7.5		683	
	140	6.7	2.7	10		752	
	93.3	9.5	1.9	15		861	
	70	12	1.5	20		948	
	56	14	1.5	25		1021	
	46.7	16	1.3	30		1085	
	35	19	0.9	40		1194	
	28	23	0.8	50		1286	
	46.7	17.2	2.6	30		2087	
	35	21	1.9	40		2298	
	28	25	1.5	50		2475	

性能参数表 Performance

P1(Kw)	n2(1/min)	M2(Nm)	F.S.	i	减速机型号Type	Fr2(N)	
0.12	23	28	1.3	60	NMRV040	2630	
	17.5	34	1.0	80		2895	
	14	38	0.8	100		3118	
	23.3	29	2.3	60	NMRV050	3610	
	17.5	35	1.9	80		3973	
	14	40	1.4	100		4280	
0.18	280	5.3	3.4	5	NMRV030	597	
	186.7	7.8	2.3	7.5		683	
	140	10	1.8	10		752	
	93.3	14	1.3	15		861	
	70	18	1.0	20		948	
	56	21	1.0	25		1021	
	46.7	24	0.8	30		1085	
	70	19.2	2.0	20	NMRV040	1824	
	56	23	1.7	25		1964	
	46.7	26	1.7	30		2087	
	35	32	1.3	40		2298	
	28	38	1.0	50		2475	
	23.3	43	0.8	60		2630	
	35	32.9	2.3	40		NMRV050	3153
28	39	1.9	50	3397			
23.3	43	1.6	60	3610			
17.5	52	1.2	80	3973			
14	60	0.9	100	4280			
0.22	280	6.5	2.8	5	NMRV030		597
	186.7	10	1.9	7.5			683
	140	12	1.5	10		752	
	93.3	17	1.0	15		861	
	70	22	0.8	20		948	
	93.3	18.5	2.2	15		NMRV040	1657
	70	23	1.7	20			1824
	56	28	1.4	25	1964		
	46.7	32	1.4	30	2087		
	35	39	1.1	40	2298		
	28	47	0.8	50	2475		
	28	47.3	1.5	50	NMRV050		3397
	23.3	53	1.3	60		3610	
	17.5	64	1.0	80		3973	
0.25	280	7.6	4.5	5		NMRV040	1149
	186.7	11	3.6	7.5			1315
	140	14	2.8	10			1447
	93.3	21	1.9	15			1657
	70	27	1.5	20	1824		
	56	32	1.2	25	1964		
	46.7	36	1.3	30	2087		
	35	44	0.9	40	2298		
	70	26.9	2.7	20	NMRV050	2503	
	56	32	2.2	25		2696	
	46.7	37	2.3	30		2865	
	35	46	1.7	40		3153	
	28	54	1.4	50		3397	
	23.3	60	1.1	60		3610	
17.5	72	0.9	80	3973			

性能参数表 Performance

P1(Kw)	n2(1/min)	M2(Nm)	F.S.	i	减速机型号Type	Fr2(N)
0.25	28	56.3	2.4	50	NMRV063	4440
	23.3	63	2.0	60		4719
	17.5	78	1.6	80		5193
	14	87	1.4	100	5595	
	17.5	81.9	2.3	80	NMRV075	6130
	14	94	1.9	100	6603	
0.37	280	11.2	3.0	5	NMRV040	1149
	186.7	16	2.4	7.5		1315
	140	21	1.9	10		1447
	93.3	31	1.3	15		1657
	70	39	1.0	20		1824
	56	47	0.8	25		1964
	46.7	53	0.8	30	2087	
	140	21.7	3.3	10	NMRV050	1987
	93.3	31	2.4	15		2274
	70	40	1.8	20		2503
	56	48	1.5	25		2696
	46.7	55	1.5	30		2865
35	68	1.1	40	3153		
28	80	0.9	50	3397		
23.3	89	0.8	60	3610		
35	70.7	2.1	40	NMRV063	4122	
28	83	1.6	50		4440	
23.3	94	1.4	60		4719	
17.5	115	1.1	80		5193	
14	129	0.9	100		5595	
23.3	98.4	2.0	60		5569	
17.5	121	1.6	80	NMRV075	6130	
14	139	1.3	100		6603	
0.55	280	16.7	2.0	5	NMRV040	1149
	186.7	24	1.6	7.5		1315
	140	32	1.3	10		1447
	93.3	46	0.9	15		1657
	280	16.7	3.7	5	NMRV050	1577
	186.7	25	2.9	7.5		1805
	140	32	2.2	10		1987
	93.3	46	1.6	15		2274
	70	59	1.2	20		2503
	56	71	1.0	25		2696
	46.7	81	1.0	30	2865	
	70	60.8	2.2	20	NMRV063	3272
56	73	1.8	25	3524		
46.7	83	1.9	30	3745		
35	105	1.4	40	4122		
28	124	1.1	50	4440		
23.3	140	0.9	60	4719		
35	108.1	2.0	40	NMRV075	4865	
28	129	1.6	50		5241	
23.3	146	1.4	60		5569	
17.5	180	1.1	80		6130	
14	206	0.9	100		6603	
17.5	189.1	1.5	80		NMRV090	6783
14	221	1.2	100	7306		

性能参数表 Performance

P1(Kw)	n2(1/min)	M2(Nm)	F.S.	i	减速机型号Type	Fr2(N)	
0.55	17.5	201.1	2.6	80	NMRV110	8571	
	14	236	2.0	100		9232	
0.75	280	22.8	2.7	5	NMRV050	1577	
	186.7	34	2.1	7.5		1805	
	140	44	1.6	10		1987	
	93.3	63	1.2	15		2274	
	70	81	0.9	20		2503	
	93.3	63.7	2.2	15		NMRV063	2973
	70	83	1.6	20	3272		
	56	100	1.3	25	3524		
	46.7	114	1.4	30	3745		
	35	143	1.0	40	4122		
	56	102.3	2.0	25	NMRV075		4160
	46.7	117	2.0	30		4421	
35	147	1.5	40	4865			
28	177	1.2	50	5241			
23.3	200	1.0	60	5569			
28	184.2	1.8	50	NMRV090		5799	
23.3	212	1.5	60		6163		
17.5	258	1.1	80		6783		
14	302	0.9	100		7306		
17.5	274.2	1.9	80		NMRV110	8571	
14	322	1.5	100			9232	
1.1	186.7	49.5	2.6	7.5	NMRV063	2359	
	140	65	2.0	10		2597	
	93.3	93	1.5	15		2973	
	70	122	1.1	20		3272	
	56	146	0.9	25		3524	
	46.7	167	1.0	30		3745	
	93.3	95.7	2.1	15	NMRV075	3509	
	70	123	1.7	20		3862	
	56	150	1.3	25		4160	
	46.7	171	1.3	30		4421	
	35	216	1.0	40		4865	
	35	225.1	1.6	40		NMRV090	5383
28	270	1.3	50	5799			
23.3	311	1.0	60	6163			
28	281.4	2.3	50	NMRV110	7328		
23.3	324	1.9	60		7787		
17.5	402	1.3	80		8571		
14	473	1.0	100		9232		
17.5	408.2	2.1	80		NMRV130	11210	
14	480	1.5	100			12076	
1.5	186.7	67.5	1.9	7.5	NMRV063	2359	
	140	89	1.5	10		2597	
	93.3	127	1.1	15		2973	
	70	166	0.8	20		3272	
	140	90	2.2	10		NMRV075	3065
	93.3	130	1.5	15			3509
	70	168	1.3	20	3862		
	56	205	1.0	25	4160		
	46.7	233	1.0	30	4421		

性能参数表 Performance

P1(Kw)	n2(1/min)	M2(Nm)	F.S.	i	减速机型号Type	Fr2(N)	
1.5	70	171.9	2.1	20	NMRV090	4273	
	56	210	1.6	25		4603	
	46.7	239	1.6	30		4890	
	35	307	1.2	40		5383	
	28	368	0.9	50		5799	
	23.3	424	0.8	60		6163	
	35	319.2	2.2	40	NMRV110	6803	
	28	384	1.7	50		7328	
	23.3	442	1.4	60		7787	
	17.5	548	0.9	80		8571	
	17.5	556.6	1.5	80	NMRV130	11210	
	14	655	1.1	100		12076	
	186.7	100.2	1.8	7.5	NMRV075	2785	
	140	132	1.5	10		3065	
93.3	191	1.0	15	3509			
2.2	186.7	101.3	2.9	7.5	NMRV090	3081	
	140	134	2.3	10		3391	
	93.3	194	1.9	15		3882	
	70	252	1.4	20		4273	
	56	308	1.1	25		4603	
	46.7	315	1.2	30		4891	
	70	255.1	2.5	20	NMRV110	5399	
	56	315	2.2	25		5816	
	46.7	356	2.0	30		6181	
	35	468	1.5	40		6803	
	28	563	1.2	50		7328	
	23.3	648	1.0	60		7787	
	35	468.2	2.2	40	NMRV130	8897	
	28	563	1.7	50		9584	
	23.3	684	1.4	60		10185	
	17.5	816	1.0	80		11210	
	186.7	136.6	1.4	7.5		NMRV075	2785
	140	180	1.1	10			3065
93.3	261	0.8	15	3509			
3	186.7	138.1	2.1	7.5	NMRV090	3081	
	140	182	1.7	10		3391	
	93.3	264	1.4	15		3882	
	70	344	1.0	20		4273	
	56	420	0.8	25		4603	
	46.7	479	0.9	30		4891	
	93.3	264	2.5	15	NMRV110	4905	
	70	348	1.9	20		5399	
	56	430	1.6	25		5816	
	46.7	485	1.5	30		6181	
	35	638	1.1	40		6803	
	28	767	0.9	50		7328	
	56	429.8	2.2	25	NMRV130	7607	
	46.7	491	2.1	30		8084	
	35	638	1.6	40		8897	
	28	767	1.3	50		9584	
	23.3	884	1.0	60		10185	
	17.5	1113	0.8	80		11210	

性能参数表 Performance

P1(Kw)	n2(1/min)	M2(Nm)	F.S.	i	减速机型号Type	Fr2(N)	
4	186.7	184.2	1.6	7.5	NMRV090	3081	
	140	243	1.3	10		3391	
	93.3	352	1.0	15		3882	
	70	458	0.8	20		4273	
	140	242.8	2.5	10		4285	
	93.3	352	1.9	15		4905	
	70	464	1.4	20	NMRV110	5399	
	56	573	1.2	25		5816	
	46.7	647	1.1	30		6181	
	56	573	1.6	25		7607	
	46.7	655	1.6	30	NMRV130	8084	
	35	851	1.2	40		8897	
	28	1023	1.0	50		9584	
	23.3	1179	0.8	60		10185	
186.7	211	1.3	7.5	NMRV090		3081	
140	291	1.1	10			3391	
93.3	422	0.9	15		3882		
4.8	186.7	221	2.5	7.5	NMRV110	3893	
	140	291	2.1	10		4285	
	93.3	422	1.6	15		4905	
	70	557	1.2	20		5399	
	56	688	1.0	25		5816	
	56	687.6	1.4	25		7607	
	46.7	786	1.3	30	NMRV130	8084	
	35	1022	1.0	40		8897	
	28	1228	0.8	50		9584	
	186.7	253.2	2.2	7.5		NMRV110	3893
	140	334	1.8	10			4285
	93.3	484	1.4	15			4905
	70	638	1.0	20	5399		
	5.5	140	333.9	2.5	10	NMRV130	5605
93.3		490	1.9	15	6416		
70		645	1.4	20	7062		
56		788	1.2	25	7607		
46.7		900	1.2	30	8084		
35		1171	0.9	40	8897		
186.7		345.3	1.6	7.5	NMRV110	3893	
140		455	1.3	10		4285	
93.3		660	1.0	15		4905	
186.7		349.2	2.1	7.5		NMRV130	5092
140		455	1.8	10	5605		
93.3		668	1.4	15	6416		
70		880	1.0	20	7062		
56		1074	0.9	25	7607		
46.7	1228	0.8	30	8084			
35	1596	0.7	40	8897			
9.2	186.7	423.6	1.3	7.5	NMRV110	3893	
	186.7	428.3	1.8	7.5	NMRV130	5092	
	140	559	1.5	10		5605	
	93.3	819	1.1	15		6416	
	70	1079	0.8	20		7062	
	56	1318	0.7	25		7607	

NRV性能参数表 Performance

(n1=1400)

M2(Nm)	i	P1(Kw)	n2(1/min)	减速机型号Type	Fr2(N)	Fr1(N)	
18	5	0.6	280	NRV030	597	150	
18	7.5	0.4	186.7		683	150	
18	10	0.3	140		752	169	
18	15	0.2	93.3		861	169	
18	20	0.2	70		984	190	
21	25	0.2	56		1021	210	
20	30	0.2	46.7		1085	210	
18	40	0.1	35		1194	210	
17	50	0.1	28		1286	210	
16	60	0.1	23.3		1367	210	
13	80	0.1	17.5		1504	210	
34	5	1.1	280		NRV040	1149	250
40	7.5	0.9	186.7			1315	294
40	10	0.7	140	1447		331	
40	15	0.5	93.3	1657		331	
39	20	0.4	70	1824		350	
38	25	0.3	56	1964		350	
45	30	0.3	46.7	2087		350	
41	40	0.2	35	2298		350	
39	50	0.2	28	2475		350	
36	60	0.2	23.3	2630		350	
33	80	0.1	17.5	2895		350	
29	100	0.1	14	3118		350	
62	5	2.0	280	NRV050		1577	350
71	7.5	1.6	186.7		1805	401	
72	10	1.2	140		1987	490	
74	15	0.9	93.3		2274	490	
73	20	0.7	70		2503	490	
70	25	0.5	56		2696	490	
84	30	0.6	46.7		2865	490	
76	40	0.4	35		3153	490	
73	50	0.3	28		3397	490	
68	60	0.3	23.3		3610	490	
65	80	0.2	17.5		3973	490	
55	100	0.2	14		4280	490	
128	7.5	2.8	186.7		NRV063	2359	500
130	10	2.2	140	2597		571	
140	15	1.6	93.3	2973		615	
135	20	1.2	70	3272		667	
130	25	1.0	56	3524		700	
160	30	1.1	46.7	3745		700	
145	40	0.8	35	4122		700	
135	50	0.6	28	4440		700	
130	60	0.5	23.3	4719		700	
122	80	0.4	17.5	5193		700	
118	100	0.3	14	5595		700	

NRV性能参数表 Performance

(n1=1400)

M2(Nm)	i	P1(Kw)	n2(1/min)	减速机型号Type	Fr2(N)	Fr1(N)	
185	7.5	4.1	186.7	NRV075	2785	700	
195	10	3.2	140		3065	830	
200	15	2.3	93.3		3509	851	
210	20	1.9	70		3862	980	
200	25	1.5	56		4160	980	
230	30	1.5	46.7		4421	980	
220	40	1.1	35		4865	980	
210	50	0.9	28		5241	980	
200	60	0.8	23.3		5569	980	
190	80	0.6	17.5		6130	980	
180	100	0.5	14		6603	980	
290	7.5	6.3	186.7		NRV090	3081	900
310	10	5.1	140			3391	1082
360	15	4.1	93.3	3882		1257	
355	20	3.1	70	4273		1270	
340	25	2.4	56	4603		1270	
410	30	2.6	46.7	4891		1270	
360	40	1.8	35	5383		1270	
340	50	1.4	28	5799		1270	
320	60	1.1	23.3	6163		1270	
285	80	0.8	17.5	6783		1270	
370	100	0.7	14	7306		1270	
552	7.5	12	186.7	NRV110		3893	1200
598	10	9.8	140			4285	1463
656	15	7.5	93.3		4905	1604	
644	20	5.6	70		5399	1700	
679	25	4.7	56		5816	1700	
725	30	4.5	46.7		6181	1700	
702	40	3.3	35		6803	1700	
660	50	2.6	28		7328	1700	
616	60	2.1	23.3		7787	1700	
515	80	1.4	17.5		8571	1700	
483	100	1.1	14		9232	1700	
750	7.5	16.1	186.7		NRV130	5092	1500
820	10	13.5	140			5605	1845
920	15	10.3	93.3	6416		2070	
910	20	7.8	70	7062		2100	
930	25	6.5	56	7607		2100	
1040	30	6.4	46.7	8084		2100	
1050	40	4.9	35	8897		2100	
980	50	3.8	28	9584		2100	
900	60	3.1	23.3	10185		2100	
840	80	2.3	17.5	11210		2100	
740	100	1.7	14	12076		2100	

减速机外型尺寸 Dimensions NMRV040

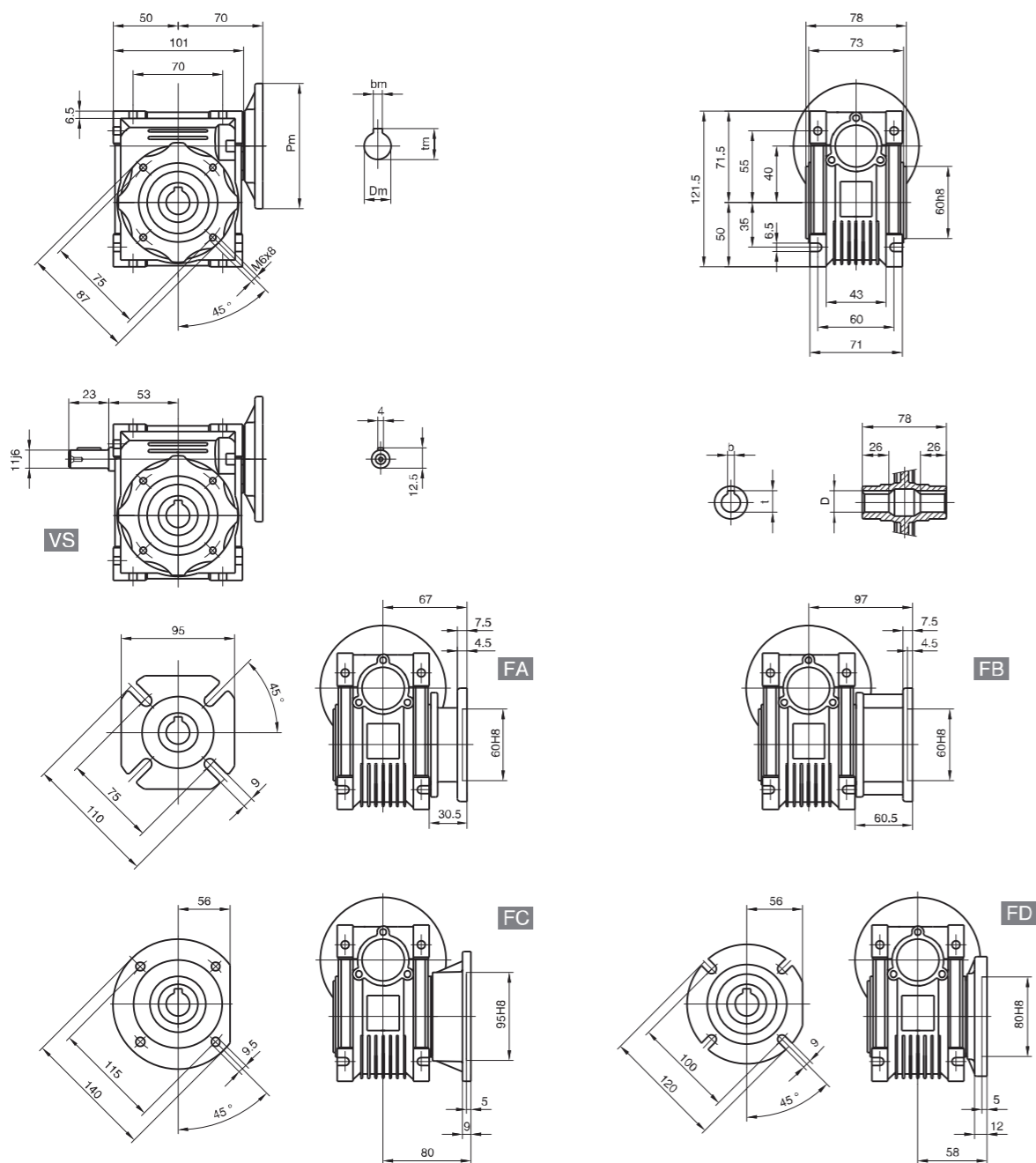

输出/Output		
D H8	b	t
18	6	20.8
(19)	(6)	(21.8)

(..)根据用户要求定制 Only on request
*不带马达重量为: 2.3kg Weight without motor: 2.3kg

输入法兰可配I(R)K系列马达 I (R) K series motors
法兰尺寸 Flange size: 90×90、104×104

马达型号 Motor model	功率 Power (W)			
5I(R)K	40	60	90	120
6I(R)K	70	120	140	200

减速机外型尺寸 Dimensions NMRV050

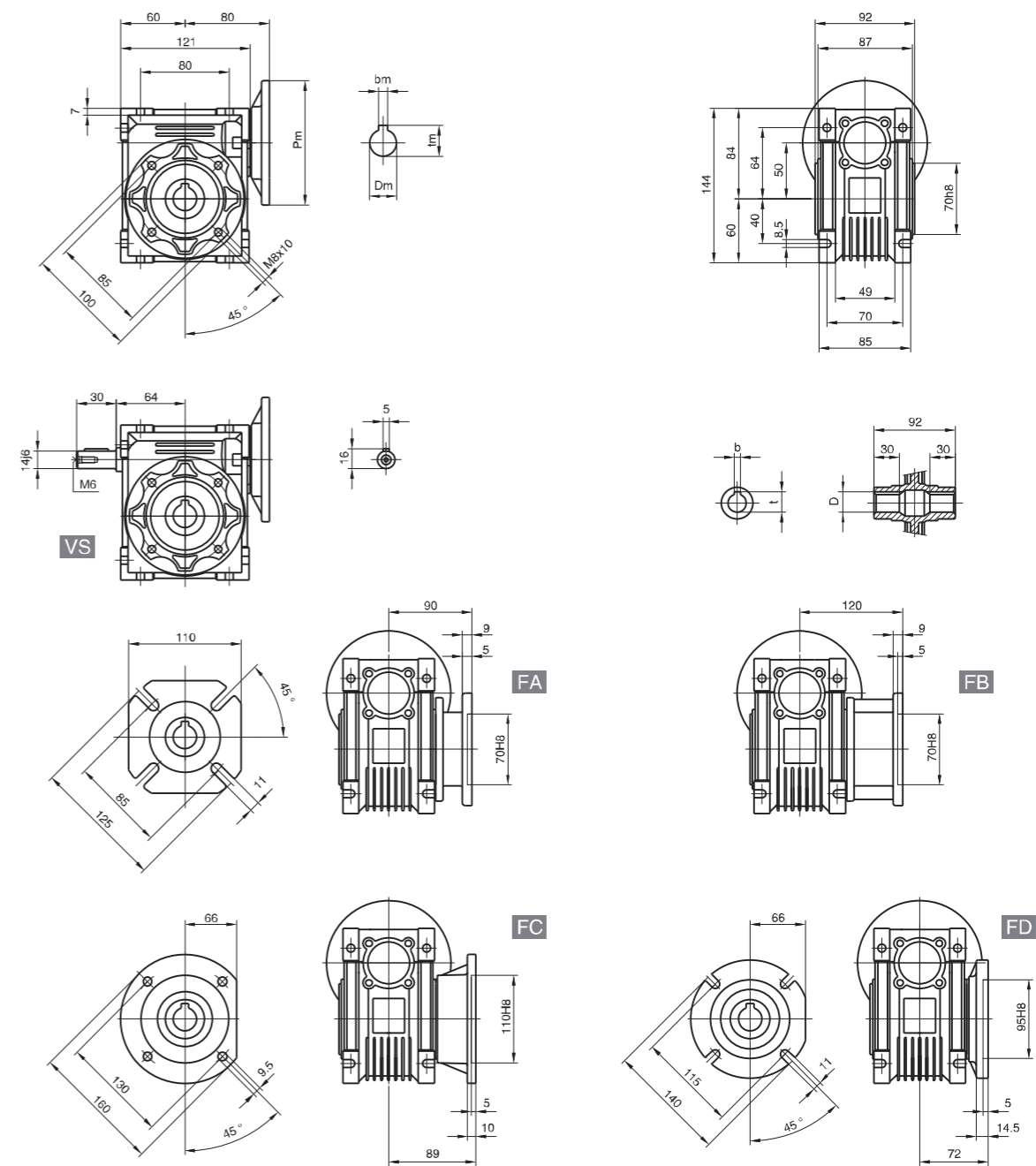

输出/Output		
D H8	b	t
25	8	28.3
(24)	(8)	(27.3)

(..)根据用户要求定制 Only on request
*不带马达重量为: 3.5kg Weight without motor: 3.5kg

输入法兰可配I(R)K系列马达 I (R) K series motors
法兰尺寸 Flange size: 104×104

马达型号 Motor model	功率 Power (W)			
6I(R)K	70	120	140	200

减速机外型尺寸 Dimensions NMRV063

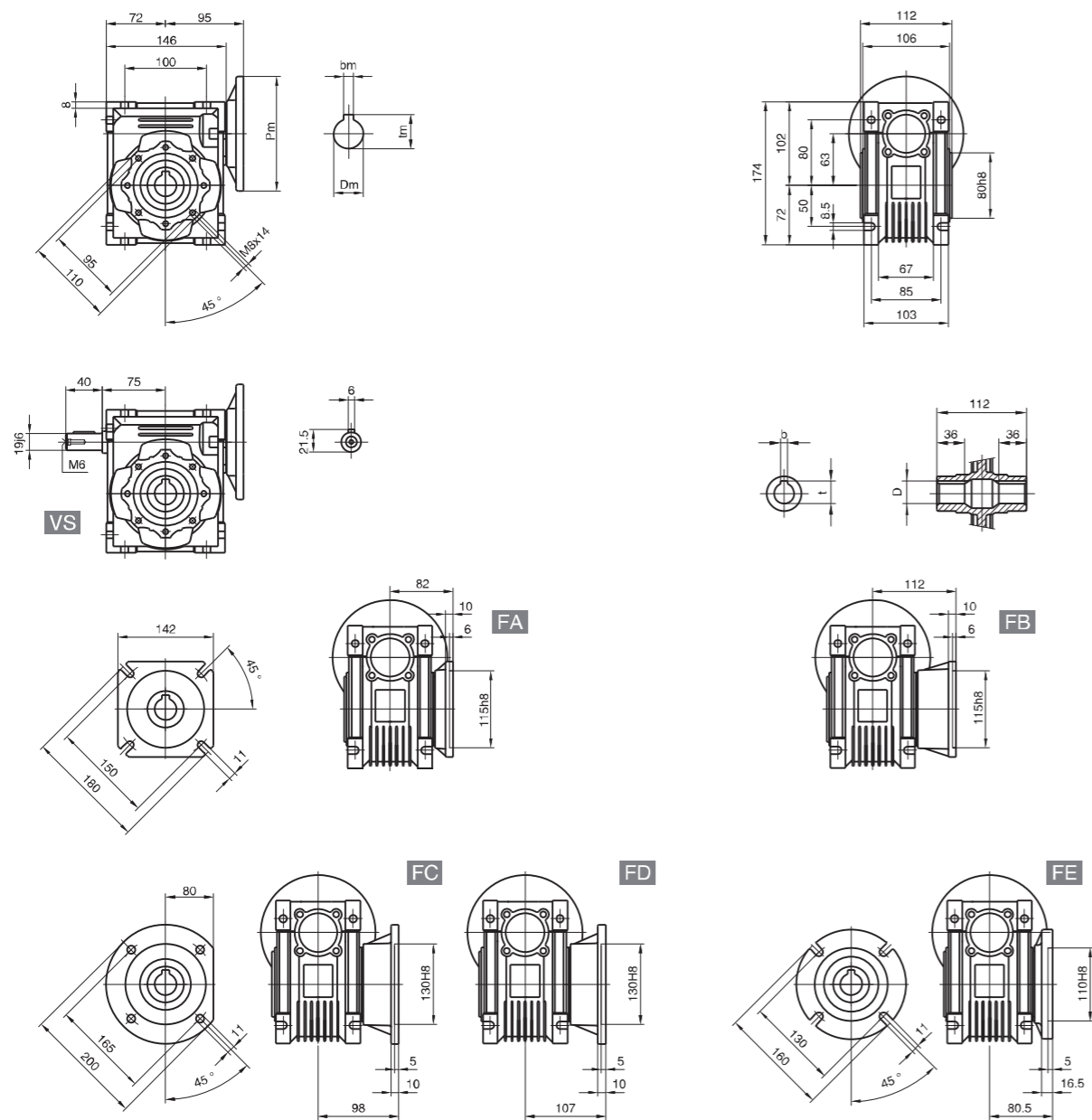

输出/Output		
D H8	b	t
25	8	28.3
(28)	(8)	(31.3)

(...)根据用户要求定制 Only on request
*不带马达重量为: 6.2kg Weight without motor: 6.2kg

减速机外型尺寸 Dimensions NMRV075

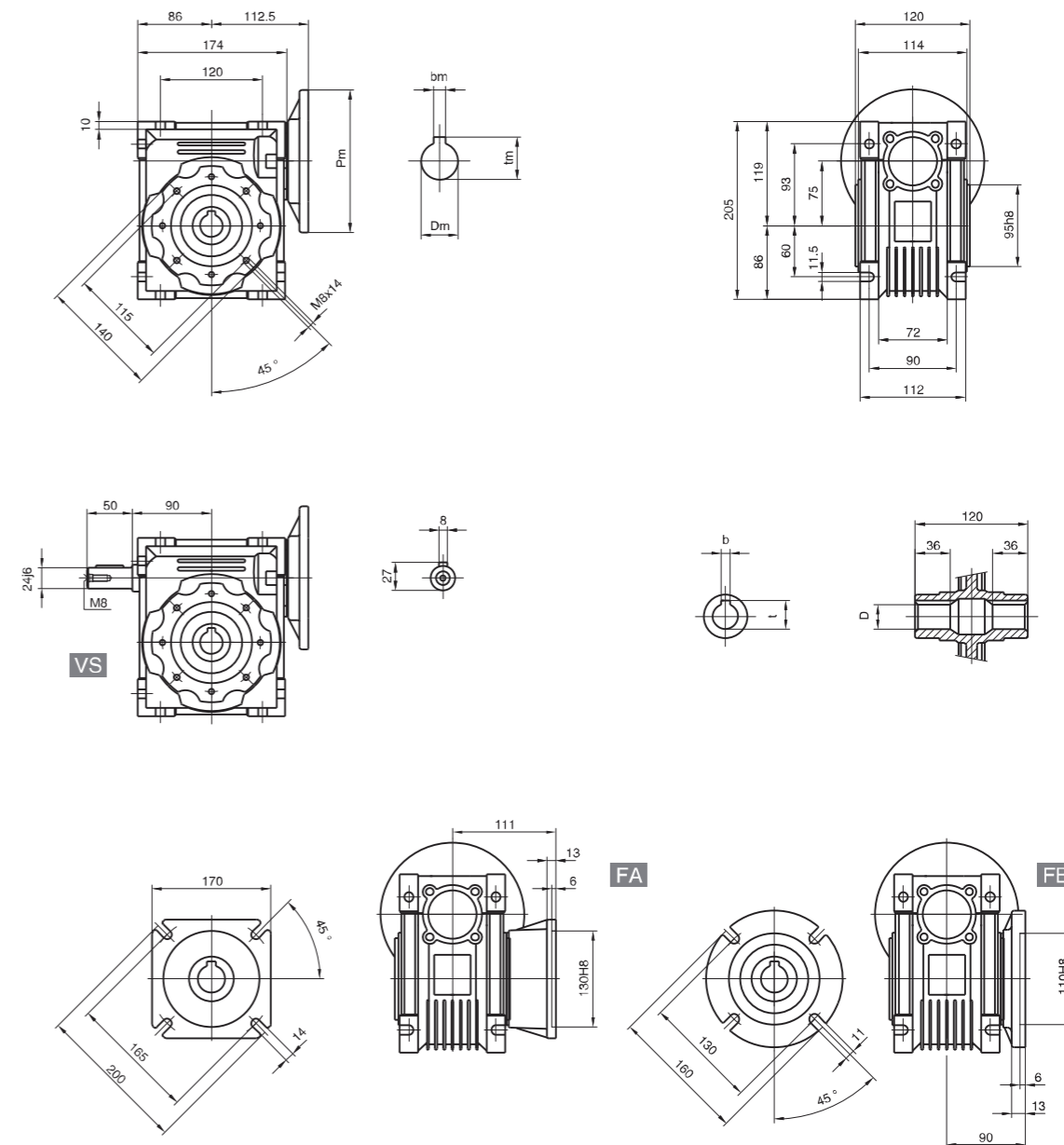

输出/Output		
D H8	b	t
28	8	31.3
(35)	(10)	(38.3)

(...)根据用户要求定制 Only on request
*不带马达重量为: 9kg Weight without motor: 9kg

减速机外型尺寸 Dimensions NMRV130

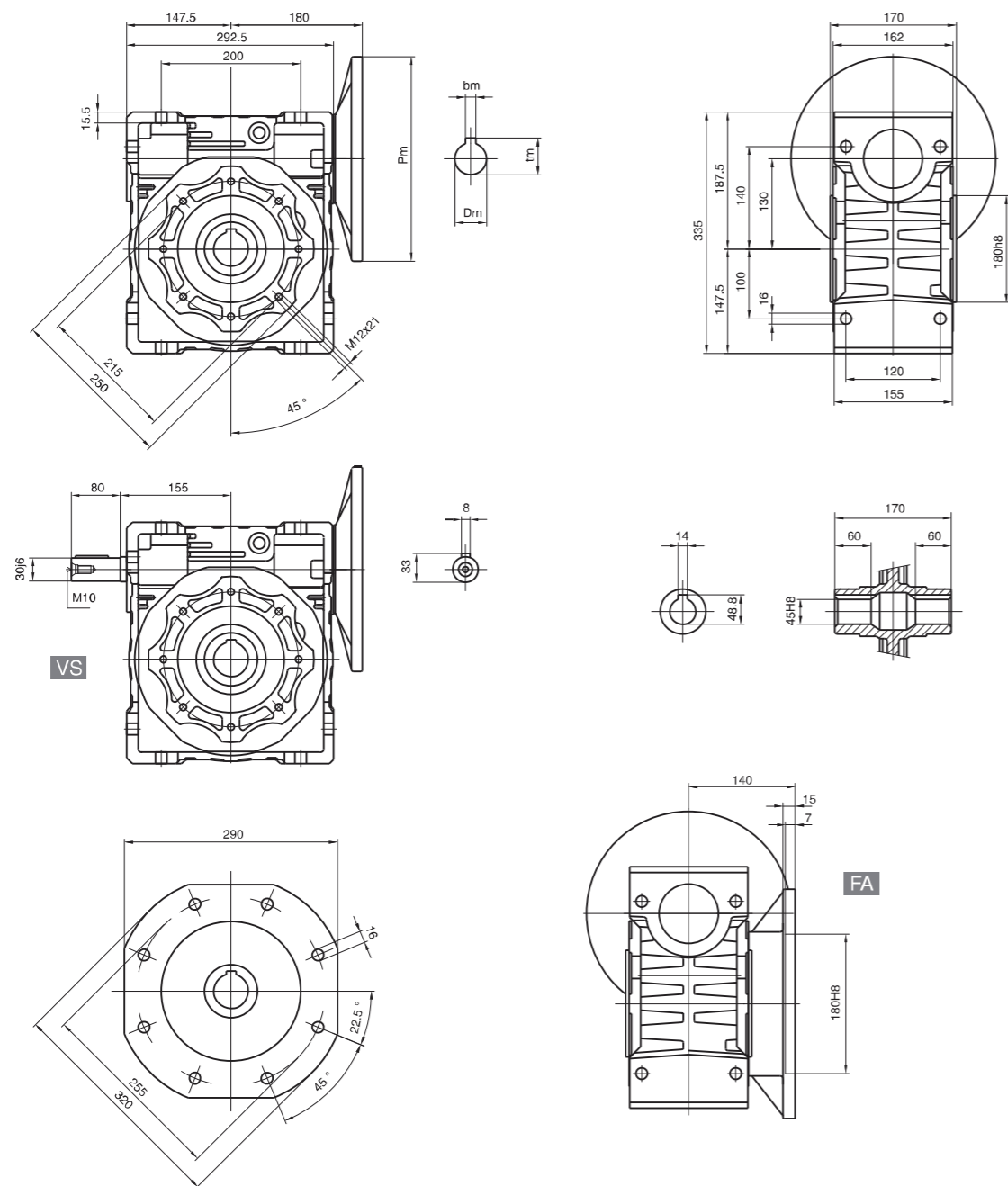

(..)根据用户要求定制 Only on request
*不带马达重量为: 48kg Weight without motor: 48kg

单向/双向输出轴尺寸 Size of single/double output shaft

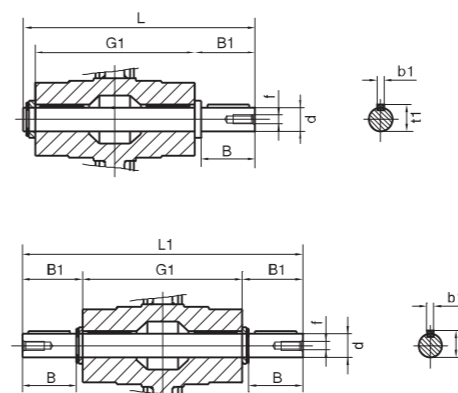

	d	B	B1	G1	L	L1	f	b1	t1
025	11g6 (9)	23 (25)	25.5 (30)	50	81 (85.5)	101	-	4 (3)	12.5 (10.2)
030	14g6	30	32.5	63	102	128	M6	5	16
040	18h6	40	43	78	128	164	M6	6	20.5
050	25h6	50	53.5	92	153	199	M10	8	28
063	25h6	50	53.5	112	173	219	M10	8	28
075	28h6	60	63.5	120	192	247	M10	8	31
090	35h6	80	84.5	140	234	309	M12	10	38
110	42h6	80	84.5	155	249	324	M16	12	45
130	45h6	80	85	170	265	340	M16	14	48.5

注: 输出轴可按用户要求定制 Only on request

双向输入轴尺寸 Size of double input shaft

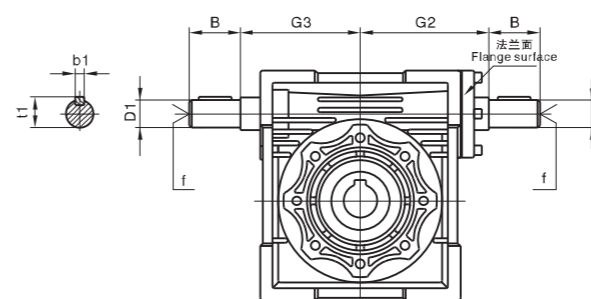

	G2, G3	D1(j6)	B	f	b1	t1
030	45	9	20	-	3	10.2
040	53	11	23	-	4	12.5
050	64	14	30	M6	5	16
063	75	19	40	M6	6	21.5
075	90	24	50	M8	8	27
090	108	24	50	M8	8	27
110	135	28	60	M10	8	31
130	155	30	80	M10	8	33

扭力臂尺寸 Sizes of torque arm

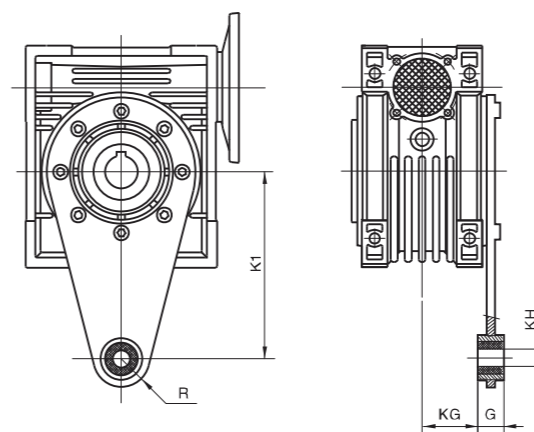

	K1	G	KG	KH	R
025	70	14	17.5	8	15
030	85	14	24	8	15
040	100	14	31.5	10	18
050	100	14	38.5	10	18
063	150	14	49	10	18
075	200	25	47.5	20	30
090	200	25	57.5	20	30
110	250	30	62	25	35
130	250	30	69	25	35

NMRV-NMRV

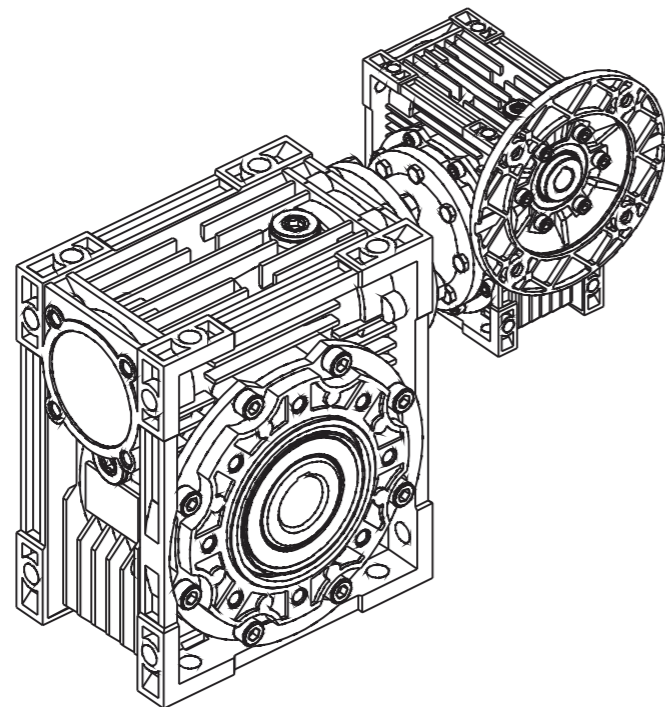

NMRV-NMRV安装方位 Mounting positions

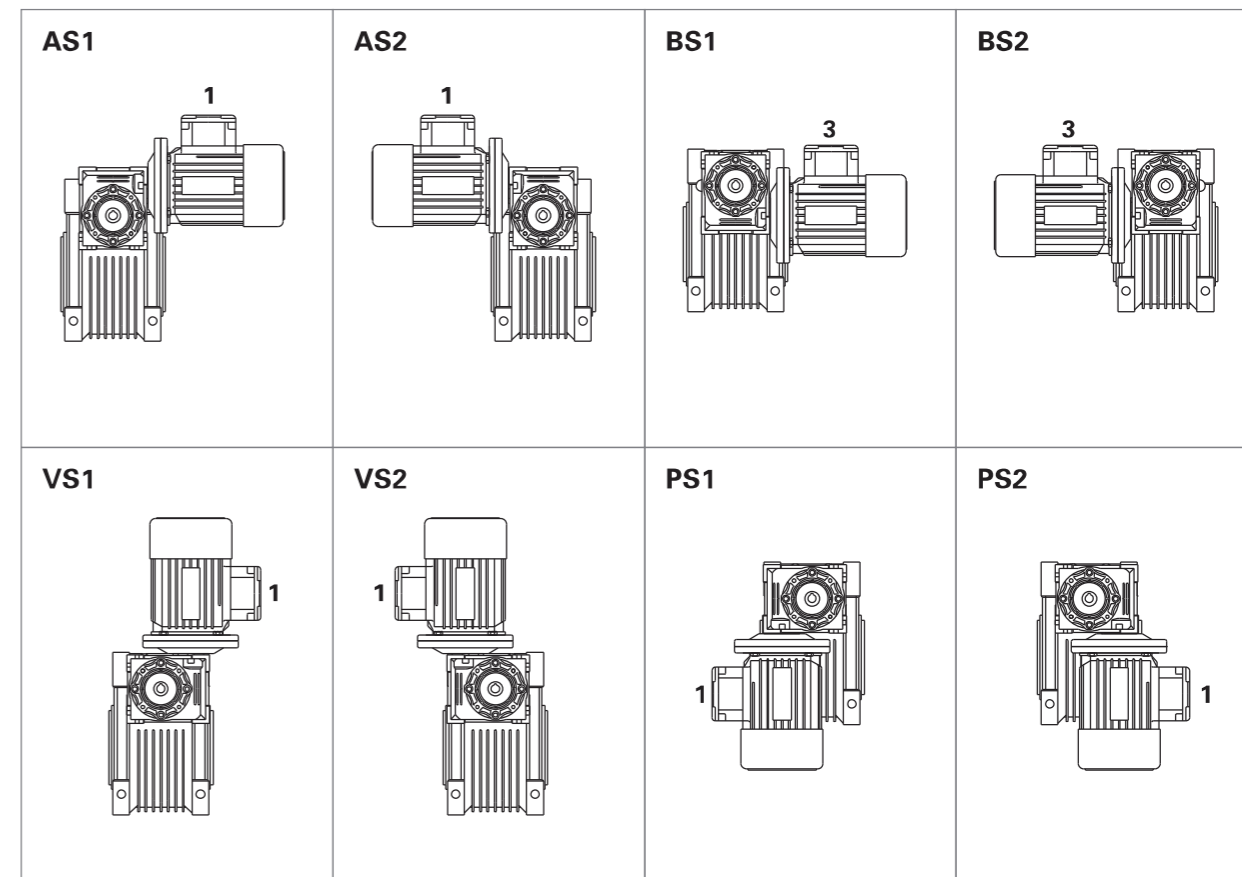

NMRV-NMRV型号标记 NMRV-NMRV Model & marker

NMRV-040/090-500-VS-F1(FA)-AS-80B5-0.75kW-AS1			
NMRV+NMRV	双蜗轮减速机 Combined worm geared motor	PAM	马达联接 Fitted for motor coupling
NRV+NMRV	配输入轴双蜗轮减速机 Combined worm reduction unit	0.75kW	马达功率 Electric motor power
040/090	蜗轮减速机中心距 Center distance	F1(FA)	输出法兰位置及型号 Output flange
500	减速比 Reduction ratio	AB	双向输出轴 Double output shaft
VS	双向输入轴 Double input shaft	80B5	电机机座号和安装结构形式 Motor mounting facility
AS	单向输出轴 Single output shaft	AS1	安装方位 Mounting position

接线盒安装方式 Position of terminal box

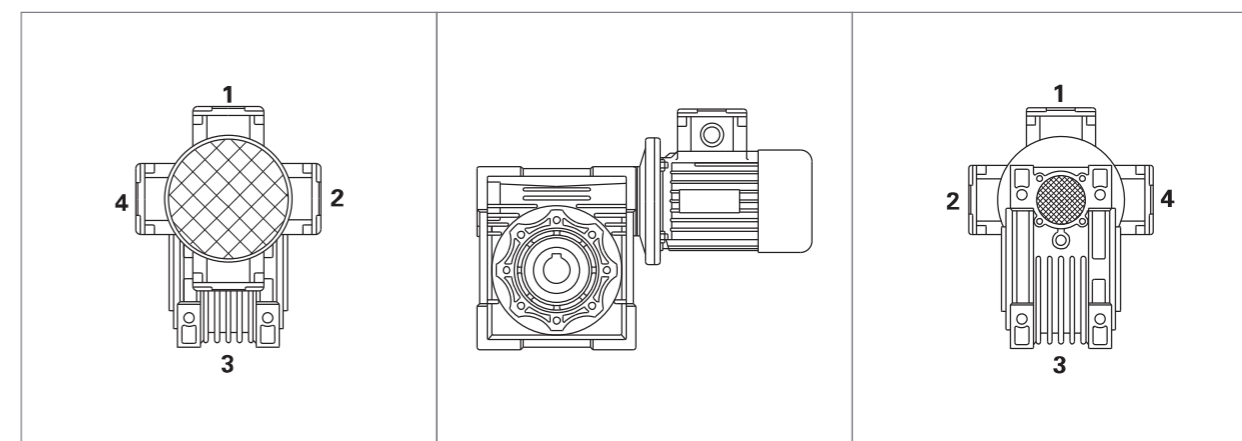

NMRV-NMRV参数表 Parameter table

型号 Type	i	n2	P1 kW1	M2 (Nm)	i1	i2
NRV 030/040	300	4.7	0.08	73	10	30
	400	3.5	0.06	65	10	40
	500	2.8	0.04	61	20	25
	600	2.3	0.04	73	20	30
	750	1.9	0.04	73	25	30
	900	0.6	0.03	73	30	30
	1200	1.2	0.02	65	30	40
	1500	0.9	0.02	73	50	30
	1800	0.8	0.02	73	60	30
	2400	0.58	0.01	65	60	40
	3200	0.4	0.01	65	80	40
	4000	0.4	0.01	33	50	80
5000	0.28	0.01	29	50	100	
NRV 030/050	300	4.7	0.15	145	10	30
	400	3.5	0.1	124	10	40
	500	2.8	0.09	120	10	50
	600	2.3	0.08	145	20	30
	750	1.9	0.07	145	25	30
	900	1.6	0.06	145	30	30
	1200	1.2	0.04	124	30	40
	1500	0.93	0.04	145	50	30
	1800	0.78	0.04	145	60	30
	2400	0.6	0.03	124	60	40
	3000	0.5	0.02	120	60	50
	4000	0.35	0.02	82	50	80
4800	0.29	0.02	82	60	80	
NRV 030/063	300	4.7	0.24	230	7.5	40
	400	3.5	0.19	230	10	40
	500	2.8	0.15	216	10	50
	600	2.3	0.13	230	15	40
	750	1.9	0.11	216	15	50
	900	1.6	0.09	198	15	60
	1200	1.2	0.08	230	30	40
	1500	0.93	0.06	216	30	50
	1800	0.78	0.05	198	30	60
	2400	0.58	0.05	230	60	40
	3000	0.47	0.04	216	60	50
	4000	0.35	0.03	172	50	80
5000	0.28	0.02	150	50	100	
NRV 040/075	300	4.7	0.36	390	10	30
	400	3.5	0.27	360	10	40
	500	2.8	0.21	320	10	50
	600	2.3	0.19	390	20	30
	750	1.9	0.16	390	25	30
	900	1.6	0.14	390	30	30
	1200	1.2	0.11	360	30	40
	1500	0.93	0.1	390	50	30
	1800	0.78	0.09	390	60	30
	2400	0.58	0.07	360	60	40
	3000	0.47	0.05	320	60	50
	4000	0.35	0.04	250	50	80
5000	0.28	0.03	230	50	100	

型号 Type	i	n2	P1 kW1	M2 (Nm)	i1	i2
NRV 040/090	300	4.7	0.56	610	7.5	40
	400	3.5	0.43	610	10	40
	500	2.8	0.34	560	10	50
	600	2.3	0.3	610	15	40
	750	1.9	0.23	560	15	50
	900	1.6	0.19	505	15	60
	1200	1.2	0.17	610	30	40
	1500	0.93	0.14	560	30	50
	1800	0.78	0.11	505	30	60
	2400	0.58	0.11	610	60	40
	3000	0.47	0.08	560	60	50
	4000	0.35	0.08	460	50	80
5000	0.28	0.06	410	50	100	
NRV 050/110	300	4.7	0.95	1100	10	30
	400	3.5	0.69	1030	10	40
	500	2.8	0.56	1000	10	50
	600	2.3	0.48	1030	15	40
	750	1.9	0.43	1100	25	30
	900	1.6	0.38	1100	30	30
	1200	1.2	0.27	1030	30	40
	1500	0.93	0.28	1100	50	30
	1800	0.78	0.23	1100	60	30
	2400	0.58	0.17	1030	60	40
	3000	0.47	0.14	1000	60	50
	4000	0.35	0.12	780	50	80
5000	0.28	0.09	710	50	100	
NRV 063/130	300	4.7	1.48	1760	10	30
	400	3.5	1.09	1650	10	40
	500	2.8	0.86	1550	10	50
	600	2.3	0.76	1650	15	40
	750	1.9	0.66	1760	25	30
	900	1.6	0.58	1760	30	20
	1200	1.2	0.43	1650	30	40
	1500	0.93	0.39	1760	50	30
	1800	0.78	0.35	1760	60	20
	2400	0.58	0.25	1650	60	40
	3000	0.47	0.2	1550	60	50
	4000	0.35	0.15	1220	50	80
5000	0.28	0.11	1100	50	100	

NMRV-NMRV参数表 Performance table

型号 Type	i	n2	P1 kW1	M2 (Nm)
NMRV030/040	300	4.7	0.09	88
	400	3.5	0.06	70
	500	2.8	0.06	96
	600	2.3	0.06	104
	750	1.9	0.06	121
	900	1.6	0.06	139
	1200	1.2	0.06	166
	1500	0.9	0.06	196
	1800	0.8	0.06	218
	2400	0.58	0.06	261
	3000	0.4	0.06	300
	5000	0.28	0.06	338
NMRV030/050	300	4.7	0.12	119
	400	3.5	0.12	142
	500	2.8	0.12	164
	600	2.3	0.09	159
	750	1.9	0.09	185
	900	1.6	0.09	212
	1200	1.2	0.06	169
	1500	0.93	0.06	199
	1800	0.78	0.06	222
	2400	0.6	0.06	266
	3000	0.5	0.06	307
	4000	0.35	0.06	288
4800	0.29	0.06	311	
NMRV030/063	300	4.7	0.22	210
	400	3.5	0.22	271
	500	2.8	0.18	257
	600	2.3	0.12	208
	750	1.9	0.12	241
	900	1.6	0.09	200
	1200	1.2	0.09	263
	1500	0.93	0.09	305
	1800	0.78	0.06	225
	2400	0.58	0.06	276
	3000	0.47	0.06	319
	4000	0.35	0.06	306
5000	0.28	0.06	360	
NMRV040/075	300	4.7	0.37	405
	400	3.5	0.37	498
	500	2.8	0.25	384
	600	2.3	0.18	362
	750	1.9	0.18	435
	900	1.6	0.18	487

型号 Type	i	n2	P1 kW1	M2 (Nm)
NMRV040/075	1200	1.2	0.12	399
	1500	0.93	0.09	360
	1800	0.93	0.09	404
	2400	0.78	0.09	496
	3000	0.58	0.06	377
	4000	0.47	0.06	355
	5000	0.35	0.06	419
NMRV040/090	300	2.8	0.37	402
	400	4.7	0.37	523
	500	3.5	0.37	611
	600	2.8	0.37	757
	750	2.3	0.25	598
	900	1.9	0.25	667
	1200	1.6	0.18	629
	1500	1.2	0.18	735
	1800	0.93	0.12	547
	2400	0.78	0.12	695
NMRV050/110	300	4.7	0.92	1069
	400	3.5	0.92	1382
	400	3.5	0.55	826
	500	2.8	0.55	984
	600	2.3	0.55	1181
	750	1.9	0.55	1411
	900	1.6	0.37	1079
	1200	1.2	0.37	1396
	1500	0.93	0.25	1064
	1800	0.78	0.25	1195
NMRV063/130	2400	0.58	0.18	1113
	3000	0.47	0.12	884
	4000	0.35	0.12	784
	5000	0.28	0.12	928
	300	4.7	1.5	1789
	400	3.5	1.5	2279
	500	2.8	1.1	1991
NMRV063/130	600	2.3	0.75	1631
	750	1.9	0.75	2005
	900	1.6	0.75	2283
	1200	1.2	0.55	2132
	1500	0.93	0.37	1674
	1800	0.78	0.37	1887
	2400	0.58	0.25	1624
	3000	0.47	0.25	1935
4000	0.35	0.25	2046	
5000	0.28	0.25	2430	

NMRV-NMRV外型尺寸 Dimensions

NMRV040-NMRV090

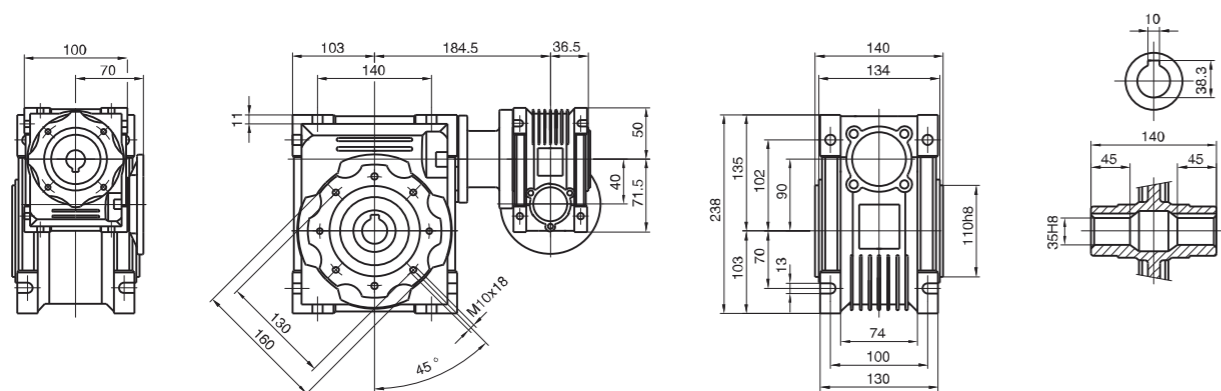

NMRV050-NMRV110

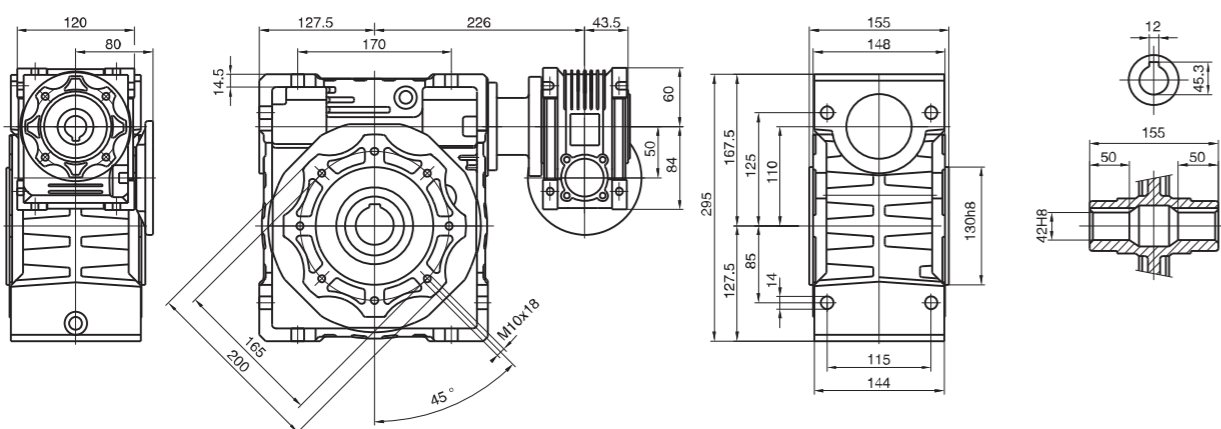

NMRV063-NMRV130

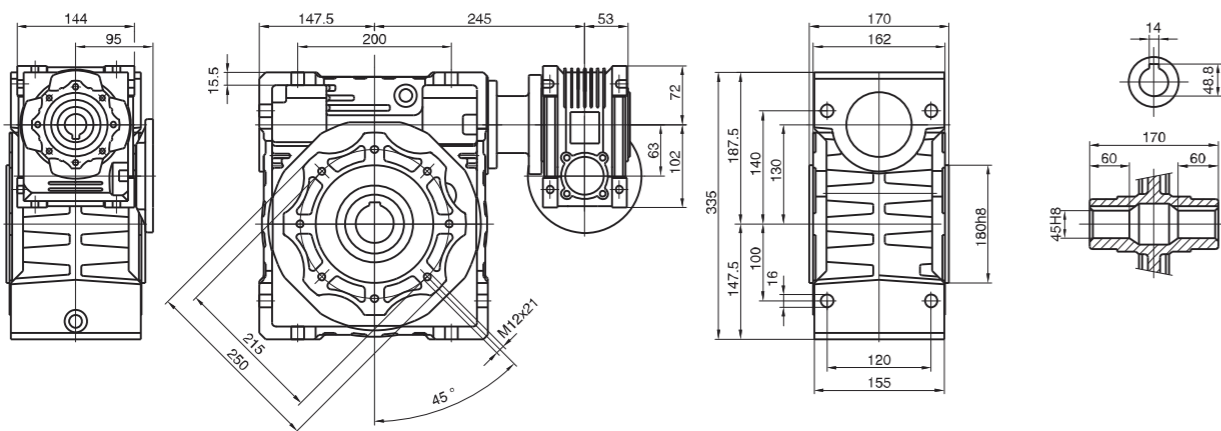

NRV-NMRV外型尺寸 Dimensions

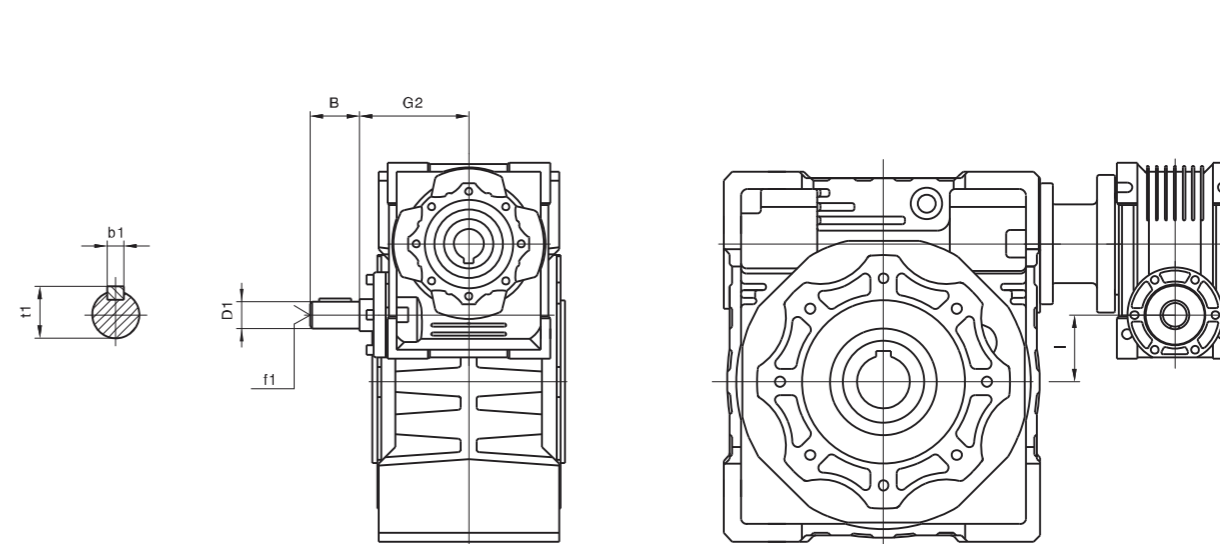

NRV-NMRV	030-040	030-050	030-063	040-075	040-090	050-110	063-130
B	20	20	20	23	23	30	40
D1	9 j6	9 j6	9 j6	11 j6	11 j6	14 j6	19 j6
G2	51	51	51	60	60	74	90
l	10	20	33	35	50	60	67
b1	3	3	3	4	4	5	6
f1	-	-	-	-	-	M6	M6
t1	10.2	10.2	10.2	12.5	12.5	16	21.5

NOTE

PAM B5外型尺寸 Dimensions

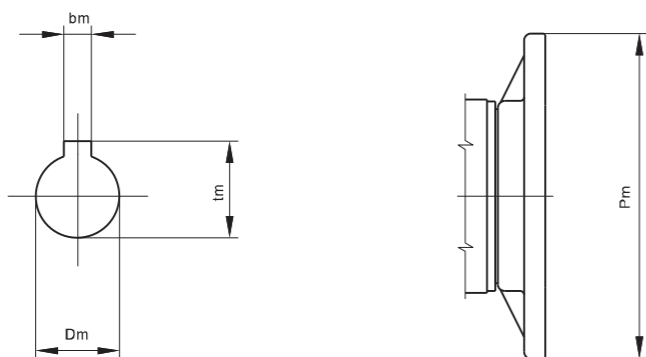

B5	IEC										
	056	063	071	080	090	100	112	132	160	180	200
Pm	120	140	160	200	200	250	250	300	350	350	400
Dm	9	11	14	19	24	28	28	38	42	48	55
bm	3	4	5	6	8	8	8	10	12	14	16
tm	10.4	12.8	16.3	21.8	27.3	31.3	31.3	41.3	45.3	51.8	59.3

PAM B14外型尺寸 Dimensions

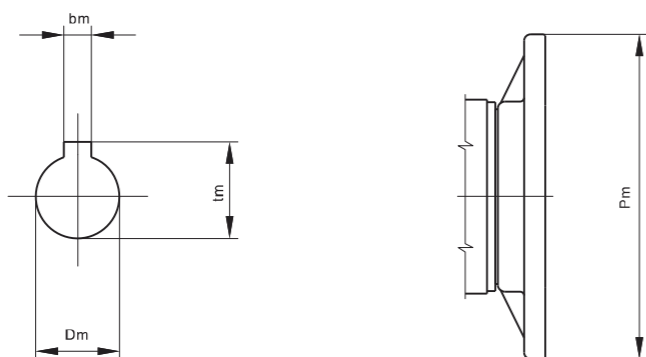

B14	IEC								
	056	063	071	080	090	110	112	132	
Pm	80	90	105	120	140	160	160	200	
Dm	9	11	14	19	24	28	28	38	
bm	3	4	5	6	8	8	8	10	
tm	10.4	12.8	16.3	21.8	27.3	31.3	31.3	41.3	